

PART NO.	UPC	DESCRIPTION	FINISH	QTY	LBS
<b>Δ CPVC Solvent Weld x Compression - Straight</b>					
PR14X C	026613138640	1/2" Nom CPVC x 3/8" OD Comp	Chrome	60	20.4
<b>PR14X C1</b>	026613136011	1/2" Nom CPVC x 3/8" OD Comp	Chrome	20	5.9
PR14X R	026613142388	1/2" Nom CPVC x 3/8" OD Comp	Rough	60	20.4
PR34X C	026613153629	1/2" Nom CPVC x 1/2" OD Comp	Chrome	60	18.3
PR34X R	026613153636	1/2" Nom CPVC x 1/2" OD Comp	Rough	60	18.3



## PEX Tube Compression Connection

For PEX Tube 3/8" OD and smaller, use plastic compression sleeve.

For PEX Tube larger than 3/8" OD, use brass compression sleeve with stainless steel tube insert.

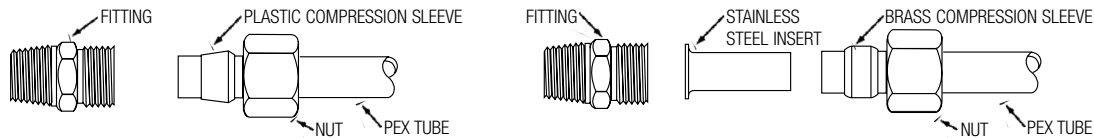

**NOTE:** All 3/8" OD PEX Risers come with plastic compression sleeve.  
All 1/2" OD PEX Risers come with stainless steel tube insert.

## Anatomy Of A BrassCraft Multi-Turn Supply Stop

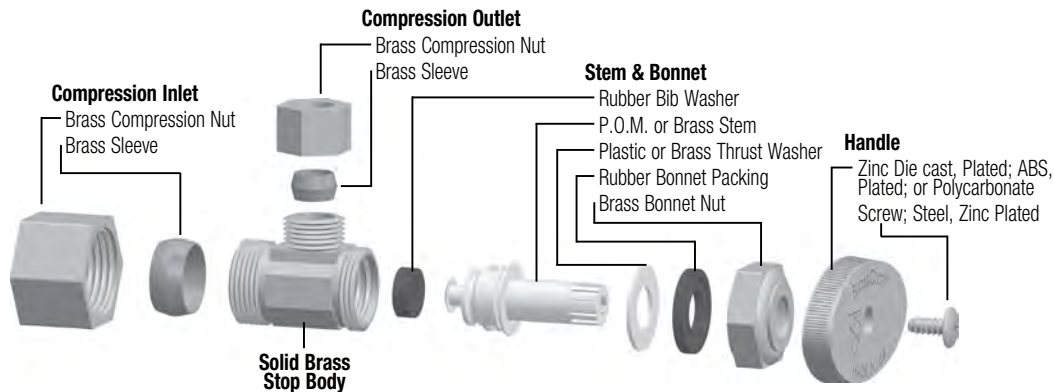

## Variations

See page 112 for Available Variations

Lock Shield Loose Key Add Prefix "S"	Lock Shield Screwdriver Slot Add Prefix "SS"	Stuffing Box Add Prefix "T"	Sweat and loose key stops are furnished with brass stems. All others are furnished with corrosion resistant P.O.M. stems. Brass Stem (Non-Sweat) Add Suffix "Z" e.g., OCR19Z C
Stuffing Box Lock Shield Loose Key Add Prefix "ST"	Stuffing Box Lock Shield Screwdriver Slot Add Prefix "SST"	Cross Handle Add Prefix "X"	Round (Brass) Handle Add Prefix "XX"

Δ CPVC pre-torqued fittings eliminate the need for tightening on the job.